



# MARTIN

**Inspired.  
Unbelievable.  
Interactive.**

## CONTACT US

- 2315 Locust Street

- Suite 2

- St. Louis MO 63103

- 314.571.7664

- [mike@risetothelocation.com](mailto:mike@risetothelocation.com)

- [www.risetothelocation.com](http://www.risetothelocation.com)

2315 Locust Street



# TOWER

REAL ESTATE GROUP





# Amenities

## *Tenant*

Flexible Leases Allow for Growth  
Onsite Rooftop Restaurant | Bar  
Gated Parking - \$50/MO  
Elevator Served  
Gigabit Fiber Internet

## *Common Areas*

Voice Interaction with Martin  
1st Floor Conference Room with Full Kitchen  
2nd Floor Conference Room with Wet Bar  
Brainstorming & Breakout Areas  
Life-Sized Board Games Throughout

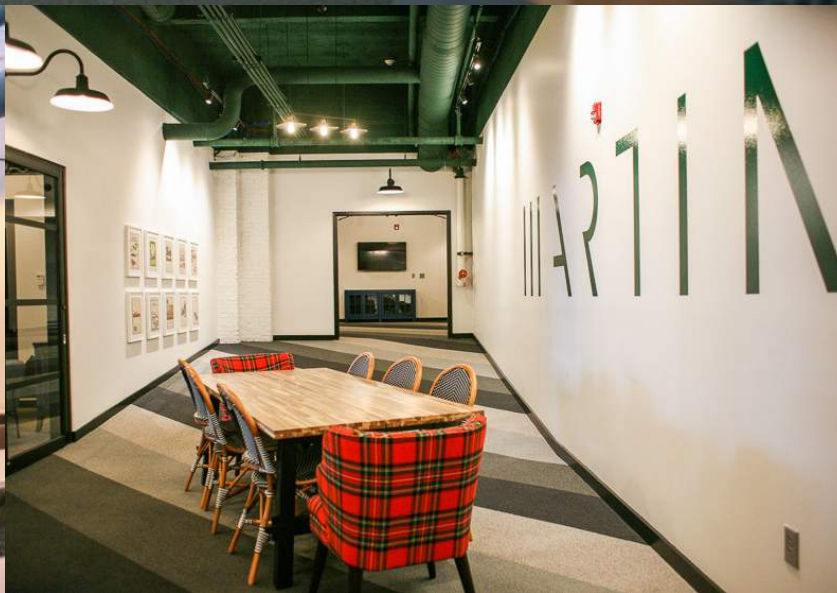

## *Neighborhood*

Located in St. Louis' Premier Design District  
Easy Access to Highway 40  
Surrounded by 16+ Restaurants  
2 Miles from Future NGA Development



1,391 SF  
\$1,738.00/MO NNN

Office #1: \$750/MO  
Office #2: \$850/MO  
Office #3: \$750/MO  
Desk Space: \$150/MO

2,507 SF  
\$3,170.00/MO NNN





**SCORCH**

alpha BRAVO

SUITE 7

SUITE 2B

SUITE 8

SUITE 12

SUITE 11

SUITE 9



**OGSYSTEMS**  
OWN THE OUTCOME

Simply Strategy  
Insights Articulated

1,391 SF  
\$1,738.00/MO NNN

Available 10/1  
2,507 SF  
\$3,170.00/MO NNN

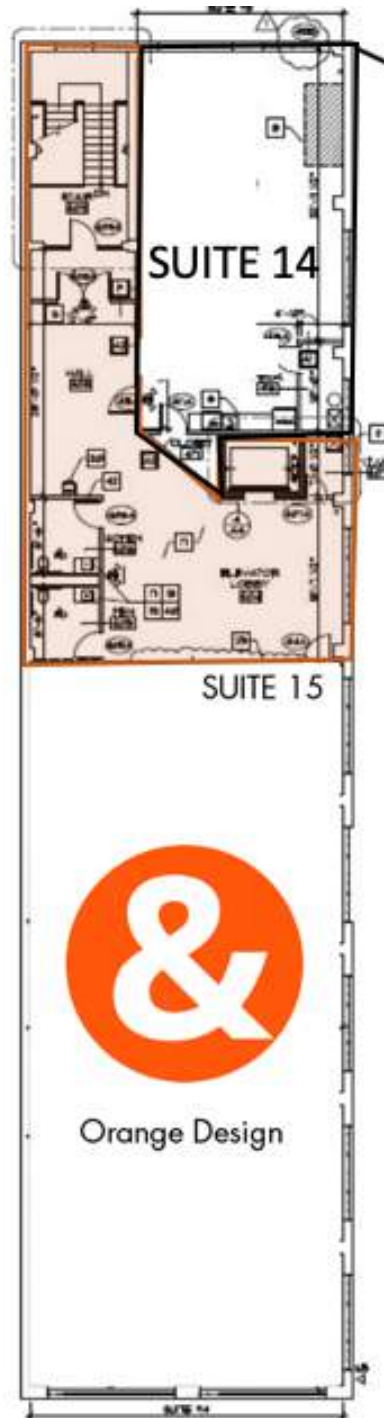

SUITE 14

1,214 SF  
\$1,618.00/MO NNN

SUITE 15



Orange Design