

4545 Lindell St
#20
St. Louis, MO 63108



For Sale: \$1,250,000

Listing Discription:

A rare opportunity to own a large luxury condo in St. Louis' most walkable neighborhood. Positioned in the highly sought after CWE neighborhood, 4545 Lindell Blvd. Unit 20, is a condo that boasts size and style. Buyers will be within walking distance of the city's best restaurants, bars and retail, not to mention two urban grocery stores and other essential amenities. With an impressive 2,631 SF living space, buyers have the flexibility to create the high end urban home they desire. The kitchen, with modern appliances and a butler's pantry, opens to a large living room with stunning views of the neighboring high rises that come to life on the wrap around balcony. The master connects to a walk-in closet and flows towards a full bathroom exhibiting dual sinks, a jacuzzi tub, and plenty of lighting. A jack and jill full bath connects the 2nd and 3rd bedroom on the west side of the unit. There is a basement storage locker, two assigned garages spaces, full-time doorman, and guest suite.

Jon Keating
jon@risetothelocation.com
314.250.1114

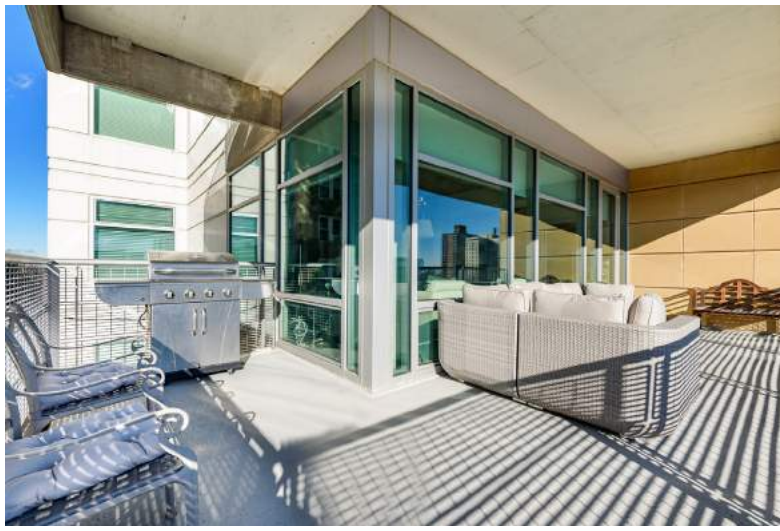

Amenties:

- | | | | |
|-----------------|-------------------------|-------------------|------------------------|
| 3 Bedrooms | Master Bedroom/Bathroom | Modern Appliances | Open Large Living Room |
| 2.5 Bathrooms | Outdoor Deck | 2 Parking Spaces | Exercise Room |
| Walk-In Closets | Basement Storage Locker | Doorman | 2,631 SF |

Neighborhood:

- | | | |
|---|--|------------------------|
| Central West End | Brentwood & Clayton -
10 minutes away | Barnes Jewish Hospital |
| Surrounded by Restaurants &
Retail | 10 Minutes to Downtown | Near Highway I -64 |
| Within Walking Distance to
Forest Park | | |