



# RETAIL FOR LEASE

4366 Manchester Ave  
St. Louis, MO 63110



TOWER  
REAL ESTATE GROUP



- 1500 SF Retail Bay
- Former Photography Studio - Easily Customizable to Suit Your Needs
- Convenient In-Unit Kitchenette and Bathroom
- High Foot Traffic Area Located in the Heart of Vibrant Grove Neighborhood
- Employee Parking In Rear
- Surrounded by Amenities and Adjacent to Urban Chestnut Brewery



TOWER  
REAL ESTATE GROUP



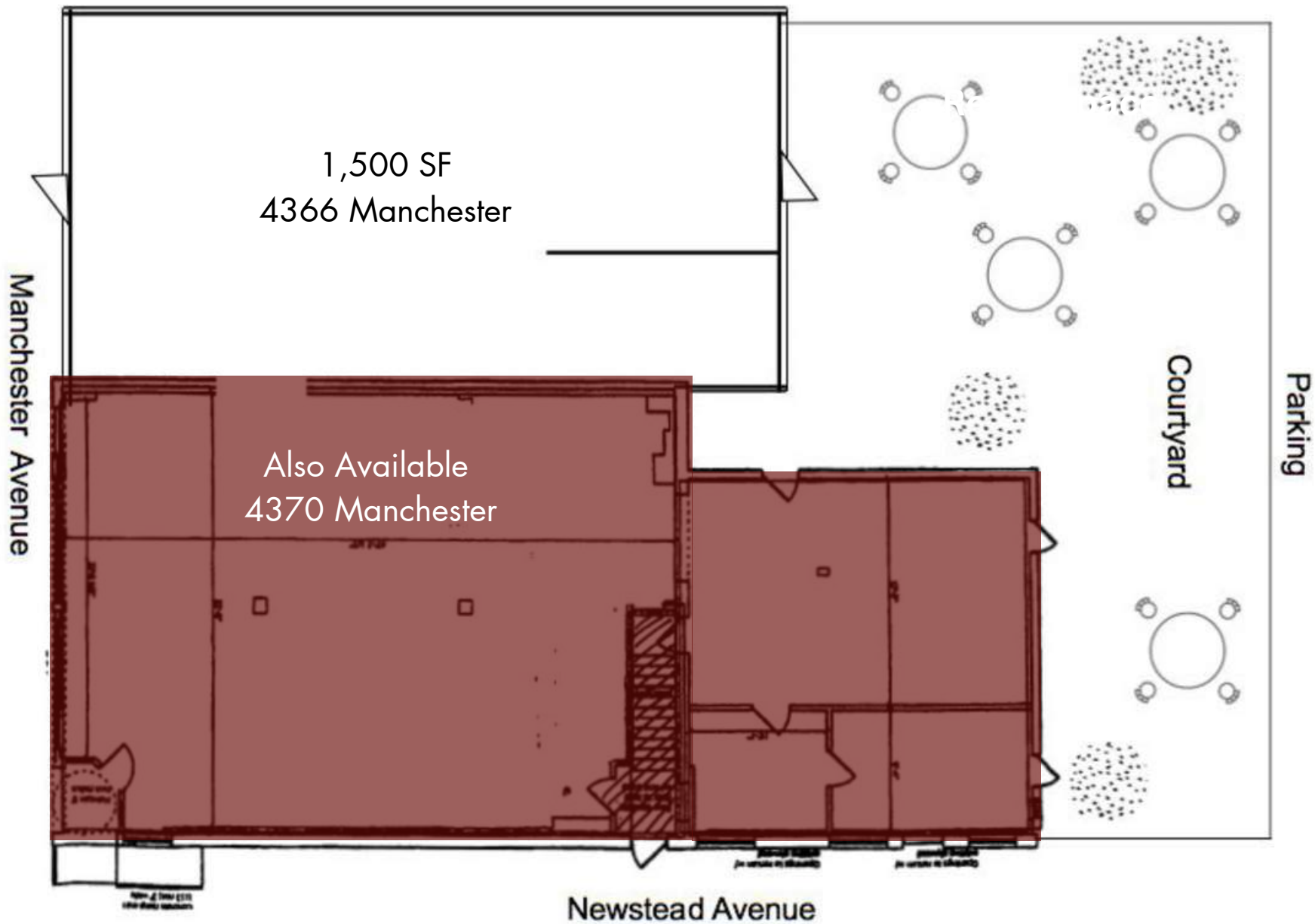

**FOR LEASE: \$19.50/SF NNN**



# The Grove

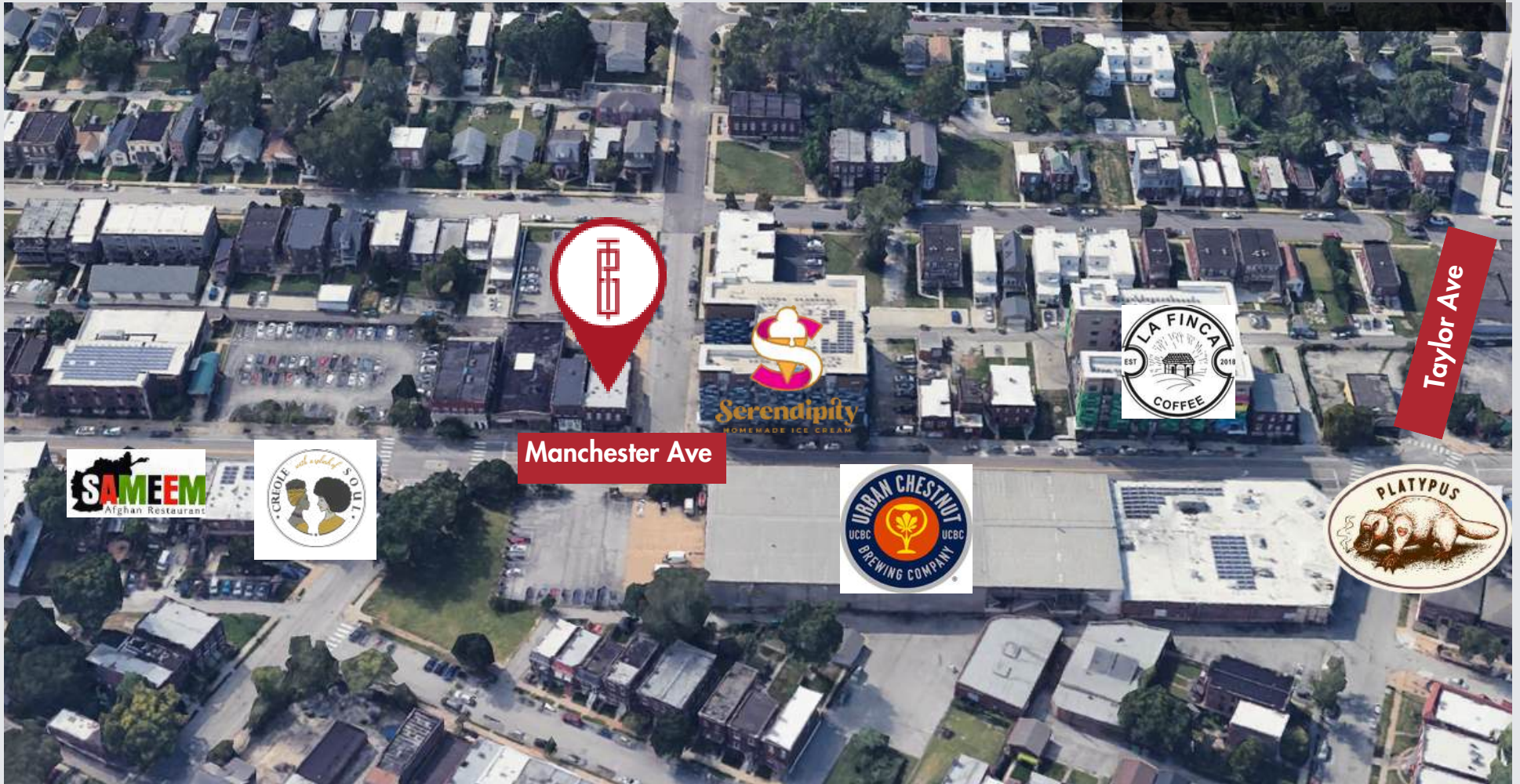

CONTACT BROKERS FOR MORE INFO



**Mike Cromie**  
314.324.0000  
[mike@risetothelocation.com](mailto:mike@risetothelocation.com)