



RETAIL FOR LEASE

4366 Manchester Ave
St. Louis, MO 63110



TOWER
REAL ESTATE GROUP



- 1500 SF Retail Bay
- Former Photography Studio - Easily Customizable to Suit Your Needs
- Convenient In-Unit Kitchenette and Bathroom
- High Foot Traffic Area Located in the Heart of Vibrant Grove Neighborhood
- Employee Parking In Rear
- Surrounded by Amenities and Adjacent to Urban Chestnut Brewery



TOWER
REAL ESTATE GROUP



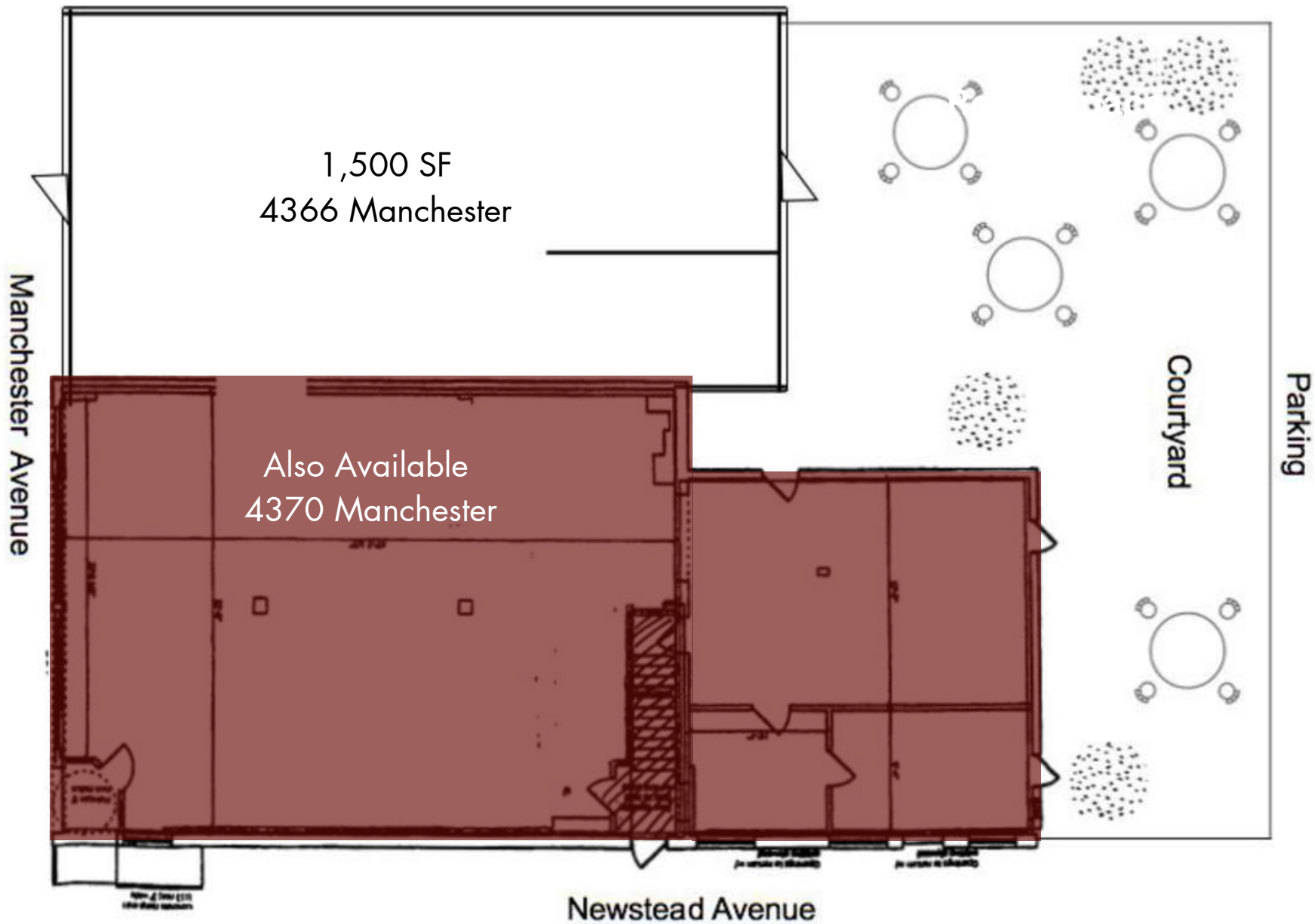

FOR LEASE: \$19.50/SF NNN

The Grove

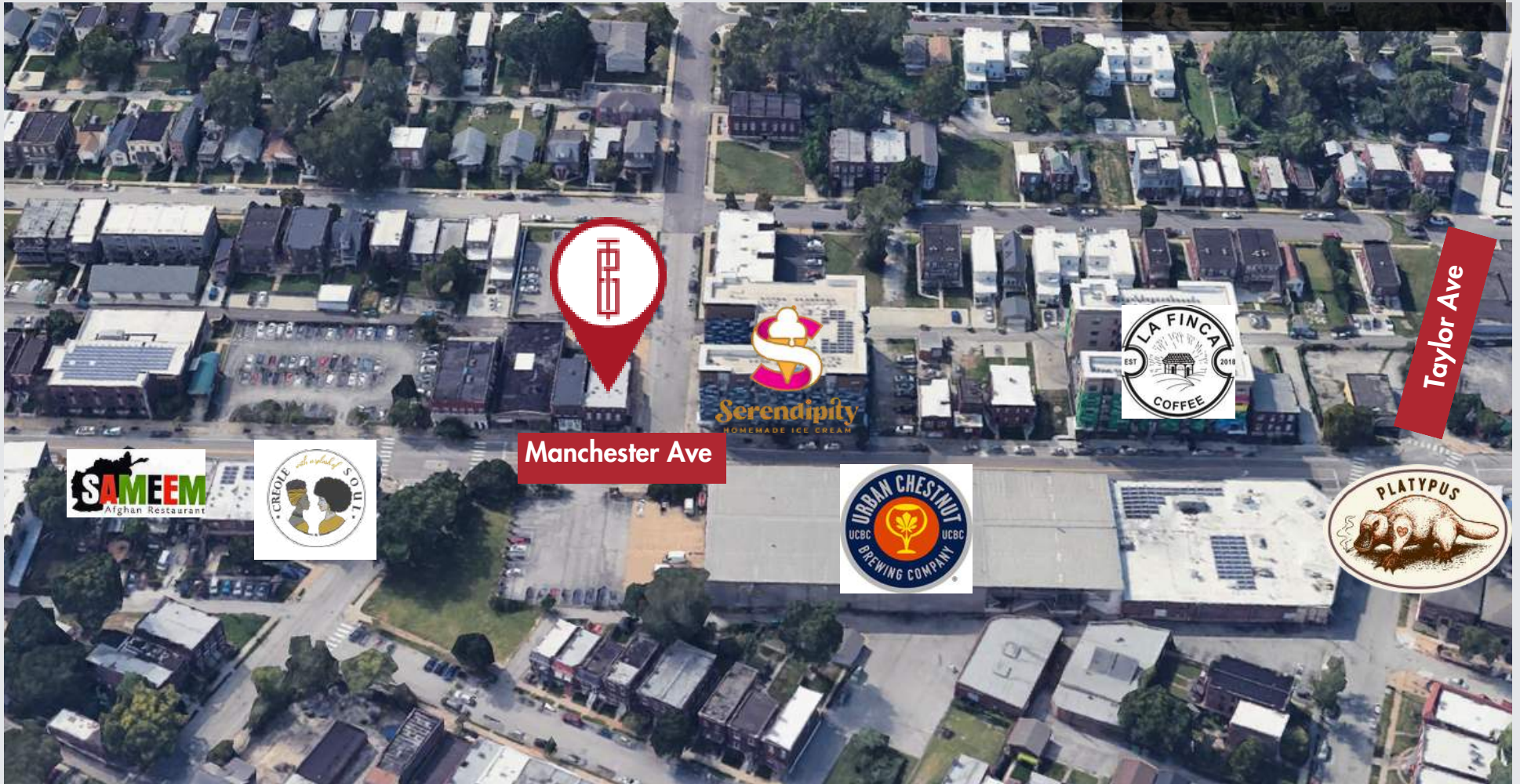

CONTACT BROKERS FOR MORE INFO



Jon Keating
314.250.1114
jon@risetothelocation.com

Mike Cromie
314.324.0000
mike@risetothelocation.com